

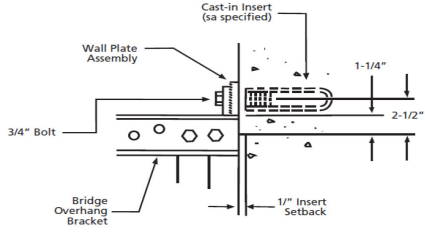

BOB Wall Plate Assembly



Description:

The OCM Wall Plate Assembly is a product that allows for direct attachment of an OCM standard, deep, junior, or short bracket to an insert that has been cast into a precast concrete beam or other concrete structure. The wall plate assembly has two pieces, the mounting wall bracket with pipe and the serrated washer for final adjustment. Both pieces are manufactured with machine threads on their face to limit the amount of vertical adjustment of the bracket. To attach the wall plate to the bracket, remove the rear 1/2" hex bolt, nut, and spacer pipe from the horizontal channels of the bracket and replace with the mounting wall bracket. Reuse the 1/2" hex bolt and nut to complete the installation of the mounting wall bracket to the overhang bracket. Next, position the mounting wall bracket over the insert in the concrete structure followed by the serrated washer. Finally, use a 3/4" bolt to connect wall plate assembly to the insert in the concrete structure.

CAUTION: Proper care and precaution must be taken using this product. Product must be visually inspected for any damage before and after every use. Please discard if any damage is visually evident. Only to be used with OCM bolts provided.

Features:

- Made from High Strength Steel.
- Used to mount OCM's Bridge Overhang Bracket.
- Easy install.

Additional Notes: 4,500 lbs safe working load with a 2:1 safety factor.

Item Number	Weight Per Piece (lbs)
WPLT-ASSY	1.65
WPLP-WASHER	0.4