

75CDIA-TOOL

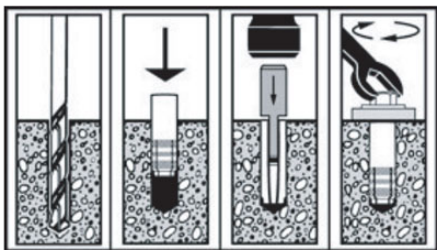

OCM Coil Thread Drop In Anchors are internally threaded Drop In Expansion Anchors used with either 1/2" or 3/4" Diameter Coil Rod, and are set in place by the use of the Setting Tool after the anchor is placed into the properly sized pre-drilled hole.

Part Number	75CDIA-TOOL
SWL (For 2000 Psi Concrete) (lbs)	1,025
D Size (in)	3/4"
Drill Bit Size Must Use (in)	1"
Weight Per Piece (lbs)	0.4
Box Quantity	1